

代码编制规则 Part Number

| 1 | 2 | 3 | 4 | 5 | 6 | 7 | 8 | 9 | 10 | 11 | 12 | 13 | 14 | 15 | 16 | 17 | 18 | 19 | 20 | 21 |
|-------------------------------|-----------------------|------------------------------|---------------------|--------------------------|-------------------------------|-------------------|-------------------------------|--------------------------|-------------------------------|------------------------------|------------------|----|----|----|----|----|----|----|----|----|
| F | C | S | 3 | B | I | S | 1 | 0 | 5 | K | A | F | D | 2 | 6 | 1 | 2 | 1 | 4 | 1 |
| 电容器类型 Capacitor Type | 产品外形 Product Shape | 额定电压代码 Rated Voltage Code | 系列代码 Series Code | 容量代码 Capacitance Code | 容量偏差 Capacitance Tolerance | 样式 Plate style | 外壳尺寸* Dimension Code W×H×T | 中心孔距 Nominal pitch P1 | 焊片间距 Gap between plates P2 | 焊片宽度Wp Width of plates Wp | 孔规格 Holeshape | | | | | | | | | |
| FC=薄膜电容器 FC=Film Capacitor | 方型=S Square=S | 850=K2 | CBB165=IS | 0.40=404 | ±5%=J | style1=A | 42.5×36×24=FD | 24=24 | 10=10 | 10=10 | φ6.5=0 | | | | | | | | | |
| | | 1000=3A | | 0.68=684 | ±10%=K | style2=B | | 26=26 | 12=12 | 12=12 | 6.5×8.5=1 | | | | | | | | | |
| | | 1200=3B | | 0.9=904 | special=S | style3=C | | 40=40 | 26=26 | 14=14 | φ8.5=0 | | | | | | | | | |
| | | 1600=3C | | 1.3=135 | | | | | | | 8.5×10.5=3 | | | | | | | | | |
| | | 2000=3D | | 2.2=225 | | | | | | | 6.5×10.5=7 | | | | | | | | | |
| | | 2500=3E | | 3.3=335 | | | | | | | 9×12=5 | | | | | | | | | |
| | | 3000=3F | | 4.2=425 | | | | | | | φ5.5=A | | | | | | | | | |
| | | | | 5.0=505 | | | | | | | | | | | | | | | | |
| | | | | 6.5=655 | | | | | | | | | | | | | | | | |
| | | | | 8.0=805 | | | | | | | | | | | | | | | | |

*外壳尺寸表

Features

- Widely used in high voltage, high frequency circuit
- Low loss and small inherent temperature rise
- Excellent active and passive flame resistant circuit
- Especially designed as snubber capacitor for IGBT

特点

- 广泛应用于高压高频脉冲电路中
- 损耗小，内部温升小
- 优异的阻燃性能
- 适合作为IGBT的吸收电容

外形图 Dimensions

Unit: mm

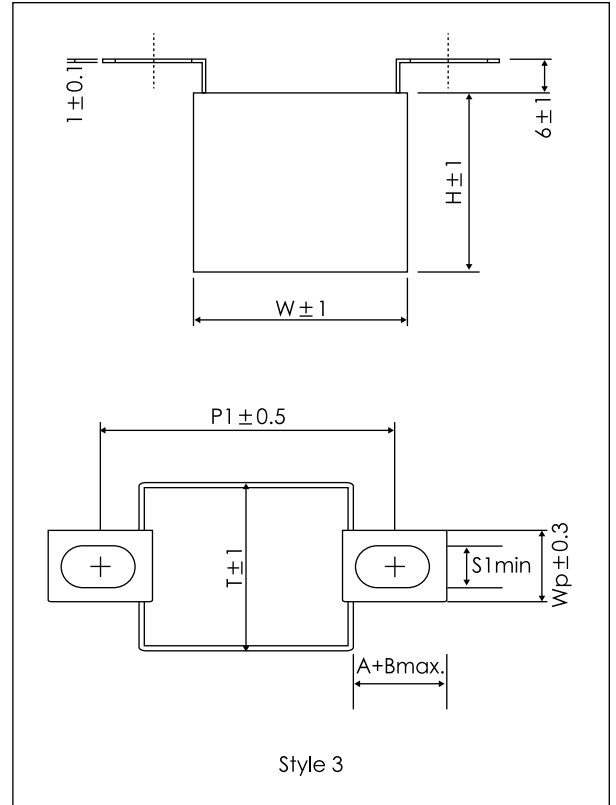
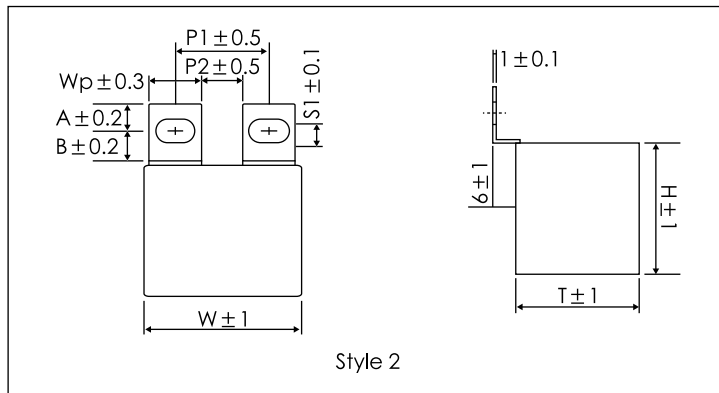
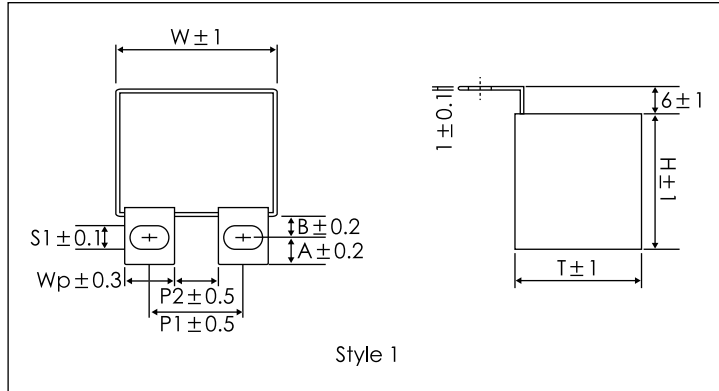

标识 Marking

| | | |
|-------------------|---|---|
| | — | 1 |
| CBB165 | — | 2 |
| 1 μ F K 1200V | — | 3 |
| J05F45 | — | 4 |

| NO. | 项目 Item |
|-----|--|
| 1 | 商标 Brand |
| 2 | 产品系列 Products series |
| 3 | 容量、偏差以及额定电压 Capacitance、Tolerance and Rated voltage |
| 4 | 日期代码 Date code |

性能特性 Specifications

| 项目 Item | 特性 Characteristics |
|--|---|
| 引用标准 Reference Standard | GB/T 17702 (IEC 61071) |
| 气候类别 Climatic Category | 40/105/56 |
| 工作温度范围 Operating Temperature Range | -40~+105°C ($\Theta_{\text{hotspot}} \leq 105^\circ\text{C}$) $\Theta_{\text{hotspot}} = 85^\circ\text{C} \sim 105^\circ\text{C}$: decreasing factor 1.35% per°C for U_R (dc) |
| 存储温度范围 Storage Temperature Range | -40~+105°C |
| 额定电压 U_R Rated Voltage | 850~3000V _{DC} |
| 电容量范围 Capacitance Range | 0.4~8.0 μF |
| 电容量偏差 Capacitance Tolerance | $\pm 5\%$ (J), $\pm 10\%$ (K) |
| 端子与端子电压 U_{TT} Voltage Between Terminals | $1.5 \times U_{\text{NDC}}$, 10s (20°C) |
| 端子与铝壳电压 U_{TC} Voltage Between Terminals and Case | 3000 V _{AC} , 10s (20°C, 50Hz) |
| 损耗角正切 Dissipation Factor | ≤ 0.0005 (20°C, 1KHz) |
| 介质损耗角正切 Dielectric Dissipation Factor | 0.0002 |
| 绝缘电阻 Insulation Resistance | $\geq 30000 \text{M}\Omega \cdot \mu\text{F}$ (20°C, 100V _{DC} , 1min) |
| 预期寿命 Life Expectancy | 100000 hours (U_R , $\Theta_{\text{hotspot}} = 70^\circ\text{C}$) |
| 失效率 Failure Rate | 100 FIT |

预期寿命曲线 Expected lifetime curve

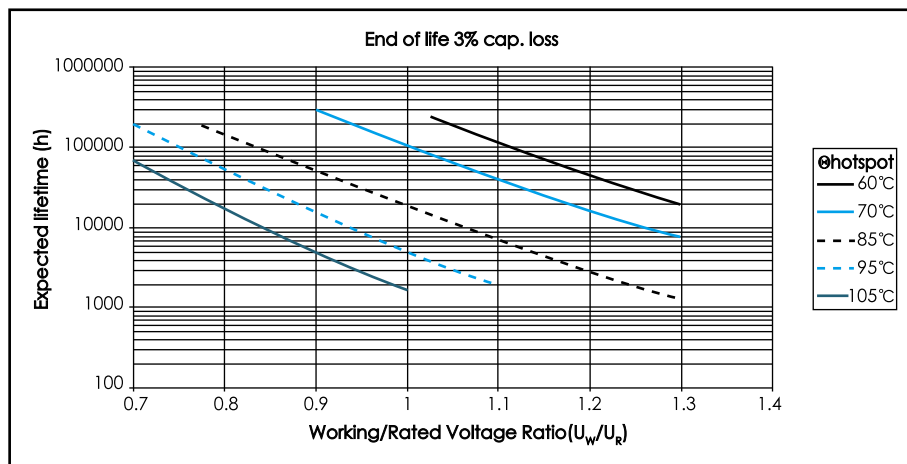

规格标准 Standard Ratings

| U _R | C _R | P/N | dV/dt | I | R _s | I _{max} | L _s | W | H | T |
|---------------------|----------------|---------------------|--------|------|----------------|--------------------|----------------|------|------|------|
| (V) | (μF) | - | (V/μs) | (A) | 100KHz (mΩ) | 100KHz @70°C(A) | (nH) | (mm) | (mm) | (mm) |
| 850Vdc (450Vac) | 1.20 | FCSK2IS125**FA***** | 375 | 450 | 10 | 11.8 | 20 | 42.5 | 28 | 24 |
| | 2.00 | FCSK2IS205**FD***** | 375 | 750 | 9 | 15.6 | 20 | 42.5 | 36 | 24 |
| | 2.50 | FCSK2IS255**FB***** | 375 | 937 | 8 | 17.6 | 20 | 42.5 | 33 | 33 |
| | 2.80 | FCSK2IS285**FC***** | 375 | 1050 | 7 | 19.8 | 20 | 42.5 | 35.5 | 33.5 |
| | 3.30 | FCSK2IS335**FF***** | 375 | 1237 | 6 | 21.5 | 20 | 42.5 | 45 | 30 |
| | 4.00 | FCSK2IS405**FE***** | 375 | 1500 | 5 | 24 | 20 | 42.5 | 43 | 42 |
| | 4.50 | FCSK2IS455**HG***** | 225 | 1012 | 5 | 24 | 20 | 57.5 | 43.5 | 29.5 |
| | 4.80 | FCSK2IS485**HH***** | 225 | 1080 | 4 | 25 | 20 | 57.5 | 45 | 30 |
| | 5.50 | FCSK2IS555**HJ***** | 225 | 1237 | 4 | 25 | 20 | 57.5 | 45 | 35 |
| | 6.50 | FCSK2IS655**HL***** | 225 | 1462 | 3 | 26 | 20 | 57.5 | 50 | 35 |
| 1000Vdc (500Vac) | 1.00 | FCS3AIS105**FA***** | 425 | 425 | 10 | 11.6 | 20 | 42.5 | 28 | 24 |
| | 1.50 | FCS3AIS155**FD***** | 425 | 637 | 9 | 15.5 | 20 | 42.5 | 36 | 24 |
| | 1.80 | FCS3AIS185**FB***** | 425 | 765 | 8 | 17.5 | 20 | 42.5 | 33 | 33 |
| | 2.00 | FCS3AIS205**FC***** | 425 | 850 | 7 | 18.8 | 20 | 42.5 | 35.5 | 33.5 |
| | 2.50 | FCS3AIS255**FF***** | 425 | 1062 | 6 | 21 | 20 | 42.5 | 45 | 30 |
| | 3.00 | FCS3AIS305**FE***** | 425 | 1275 | 5 | 23 | 20 | 42.5 | 43 | 42 |
| | 3.30 | FCS3AIS335**HG***** | 250 | 825 | 6 | 23 | 20 | 57.5 | 43.5 | 29.5 |
| | 3.50 | FCS3AIS355**HH***** | 250 | 875 | 5 | 24 | 20 | 57.5 | 45 | 30 |
| | 4.20 | FCS3AIS425**HJ***** | 250 | 1050 | 5 | 24 | 20 | 57.5 | 45 | 35 |
| | 4.80 | FCS3AIS485**HL***** | 250 | 1200 | 4 | 25 | 20 | 57.5 | 50 | 35 |
| 1200Vdc (600Vac) | 5.00 | FCS3AIS505**HK***** | 250 | 1250 | 4 | 25 | 20 | 57.5 | 45 | 45 |
| | 6.00 | FCS3AIS605**HM***** | 250 | 1500 | 4 | 28 | 20 | 57.5 | 55 | 40 |
| | 0.68 | FCS3BIS684**FA***** | 475 | 323 | 10 | 11.5 | 20 | 42.5 | 28 | 24 |
| | 1.00 | FCS3BIS105**FD***** | 475 | 475 | 10 | 15.4 | 20 | 42.5 | 36 | 24 |
| | 1.10 | FCS3BIS115**FB***** | 475 | 522 | 9 | 17.2 | 20 | 42.5 | 33 | 33 |
| | 1.30 | FCS3BIS135**FC***** | 475 | 617 | 8 | 18.6 | 20 | 42.5 | 35.5 | 33.5 |
| | 1.60 | FCS3BIS165**FF***** | 475 | 760 | 7 | 20.6 | 20 | 42.5 | 45 | 30 |
| | 2.00 | FCS3BIS205**FE***** | 475 | 950 | 7 | 22 | 20 | 42.5 | 43 | 42 |
| | 2.20 | FCS3BIS225**HG***** | 300 | 660 | 6 | 22 | 20 | 57.5 | 43.5 | 29.5 |
| | 2.50 | FCS3BIS255**HH***** | 300 | 750 | 6 | 23 | 20 | 57.5 | 45 | 30 |
| 1600Vdc (650Vac) | 2.80 | FCS3BIS285**HJ***** | 300 | 840 | 6 | 24 | 20 | 57.5 | 45 | 35 |
| | 3.30 | FCS3BIS335**HL***** | 300 | 990 | 5 | 24 | 20 | 57.5 | 50 | 35 |
| | 3.50 | FCS3BIS355**HK***** | 300 | 1050 | 5 | 25 | 20 | 57.5 | 45 | 45 |
| | 4.00 | FCS3BIS405**HM***** | 300 | 1200 | 5 | 26 | 20 | 57.5 | 55 | 40 |
| | 0.45 | FCS3CIS454**FA***** | 625 | 281 | 11 | 11.4 | 20 | 42.5 | 28 | 24 |
| | 0.60 | FCS3CIS604**FD***** | 625 | 375 | 10 | 15.2 | 20 | 42.5 | 36 | 24 |
| | 0.70 | FCS3CIS704**FB***** | 625 | 437 | 10 | 17 | 20 | 43 | 33 | 33 |
| | 0.85 | FCS3CIS854**FC***** | 625 | 531 | 9 | 18.4 | 20 | 43 | 35.5 | 33.5 |
| | 1.00 | FCS3CIS105**FF***** | 625 | 625 | 8 | 20.5 | 20 | 42.5 | 45 | 30 |
| | 1.30 | FCS3CIS135**FE***** | 625 | 812 | 7 | 21 | 20 | 42.5 | 43 | 42 |
| 2000Vdc (700Vac) | 1.50 | FCS3CIS155**HG***** | 375 | 562 | 6 | 22 | 20 | 57.5 | 43.5 | 29.5 |
| | 1.60 | FCS3CIS165**HH***** | 375 | 600 | 6 | 22 | 20 | 57.5 | 45 | 30 |
| | 1.80 | FCS3CIS185**HJ***** | 375 | 675 | 5 | 23 | 20 | 57.5 | 45 | 35 |
| | 2.00 | FCS3CIS205**HL***** | 375 | 750 | 5 | 24 | 20 | 57.5 | 50 | 35 |
| | 2.20 | FCS3CIS225**HK***** | 375 | 825 | 4 | 24 | 20 | 57.5 | 45 | 45 |
| | 2.50 | FCS3CIS255**HM***** | 375 | 937 | 4 | 25 | 20 | 57.5 | 55 | 40 |
| | 1.00 | FCS3DIS105**HG***** | 425 | 425 | 5 | 22 | 20 | 57.5 | 43.5 | 29.5 |
| | 1.10 | FCS3DIS115**HH***** | 425 | 467 | 5 | 23 | 20 | 57.5 | 45 | 30 |
| | 1.30 | FCS3DIS135**HJ***** | 425 | 552 | 4 | 23 | 20 | 57.5 | 45 | 35 |
| | 1.50 | FCS3DIS155**HL***** | 425 | 637 | 4 | 24 | 20 | 57.5 | 50 | 35 |
| 2500Vdc (725Vac) | 1.70 | FCS3DIS175**HK***** | 425 | 722 | 4 | 25 | 20 | 57.5 | 45 | 45 |
| | 1.90 | FCS3DIS195**HM***** | 425 | 807 | 3 | 25 | 20 | 57.5 | 55 | 40 |
| | 0.55 | FCS3EIS554**HC***** | 600 | 330 | 5 | 21 | 20 | 57.5 | 43.5 | 29.5 |
| | 0.60 | FCS3EIS604**HH***** | 600 | 360 | 5 | 21 | 20 | 57.5 | 45 | 30 |
| | 0.75 | FCS3EIS754**HJ***** | 600 | 450 | 4 | 23 | 20 | 57.5 | 45 | 35 |
| | 0.80 | FCS3EIS804**HL***** | 600 | 480 | 4 | 23 | 20 | 57.5 | 50 | 35 |
| 3000Vdc (750Vac) | 0.90 | FCS3EIS904**HK***** | 600 | 540 | 3 | 24 | 20 | 57.5 | 45 | 45 |
| | 1.00 | FCS3EIS105**HM***** | 600 | 600 | 3 | 25 | 20 | 57.5 | 55 | 40 |
| | 0.40 | FCS3FIS404**HC***** | 600 | 240 | 6 | 21 | 20 | 57.5 | 43.5 | 29.5 |
| | 0.40 | FCS3FIS404**HH***** | 600 | 240 | 6 | 21 | 20 | 57.5 | 45 | 30 |
| | 0.50 | FCS3FIS504**HJ***** | 600 | 300 | 5 | 22 | 20 | 57.5 | 45 | 35 |
| | 0.55 | FCS3FIS554**HL***** | 600 | 330 | 5 | 23 | 20 | 57.5 | 50 | 35 |
| 3000Vdc (750Vac) | 0.65 | FCS3FIS654**HK***** | 600 | 390 | 4 | 23 | 20 | 57.5 | 45 | 45 |
| | 0.70 | FCS3FIS704**HM***** | 600 | 420 | 4 | 24 | 20 | 57.5 | 55 | 40 |

可根据客户要求定制。Customer products are available on request.